

REVISION HISTORY			
REV	DESCRIPTION	DATE	APPROVED

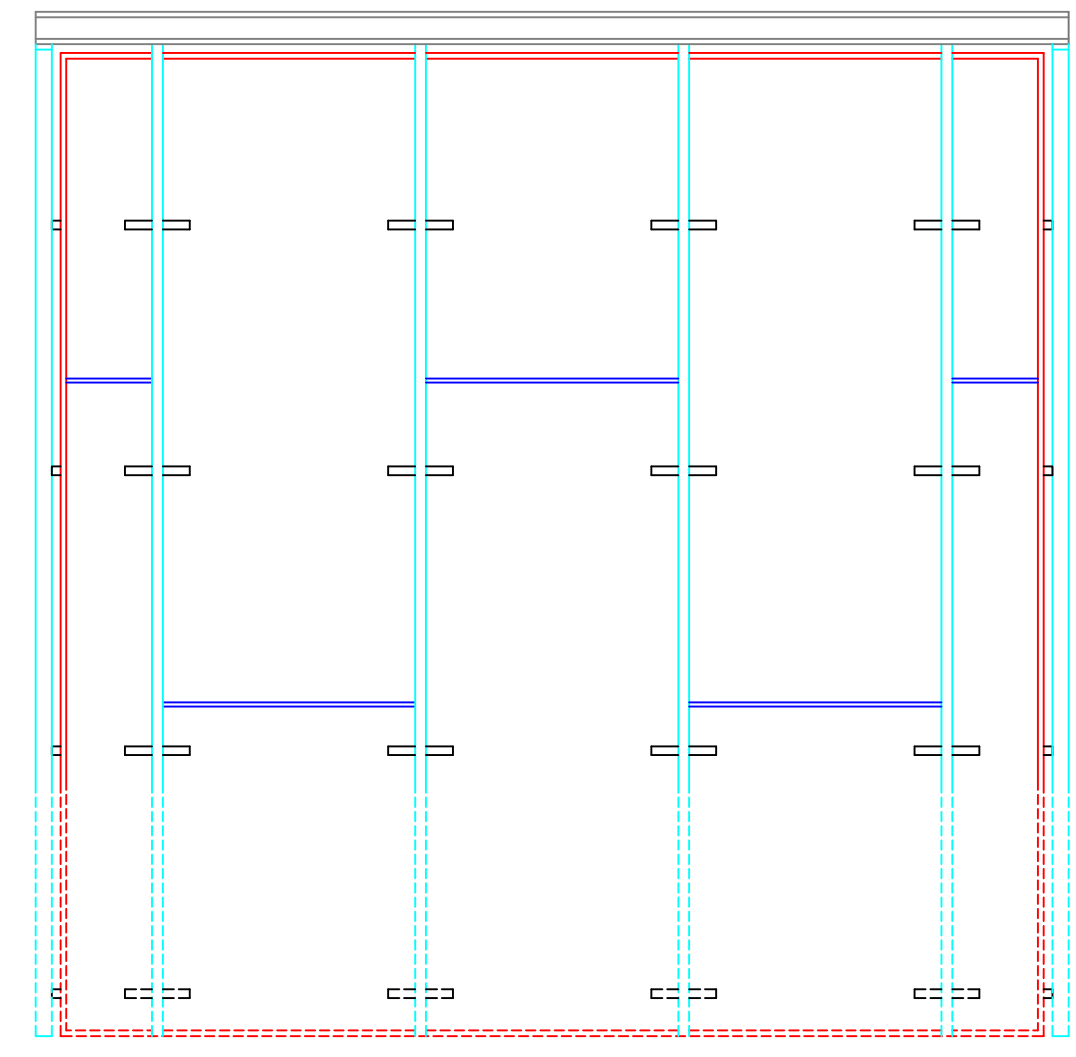

ELEVATION A

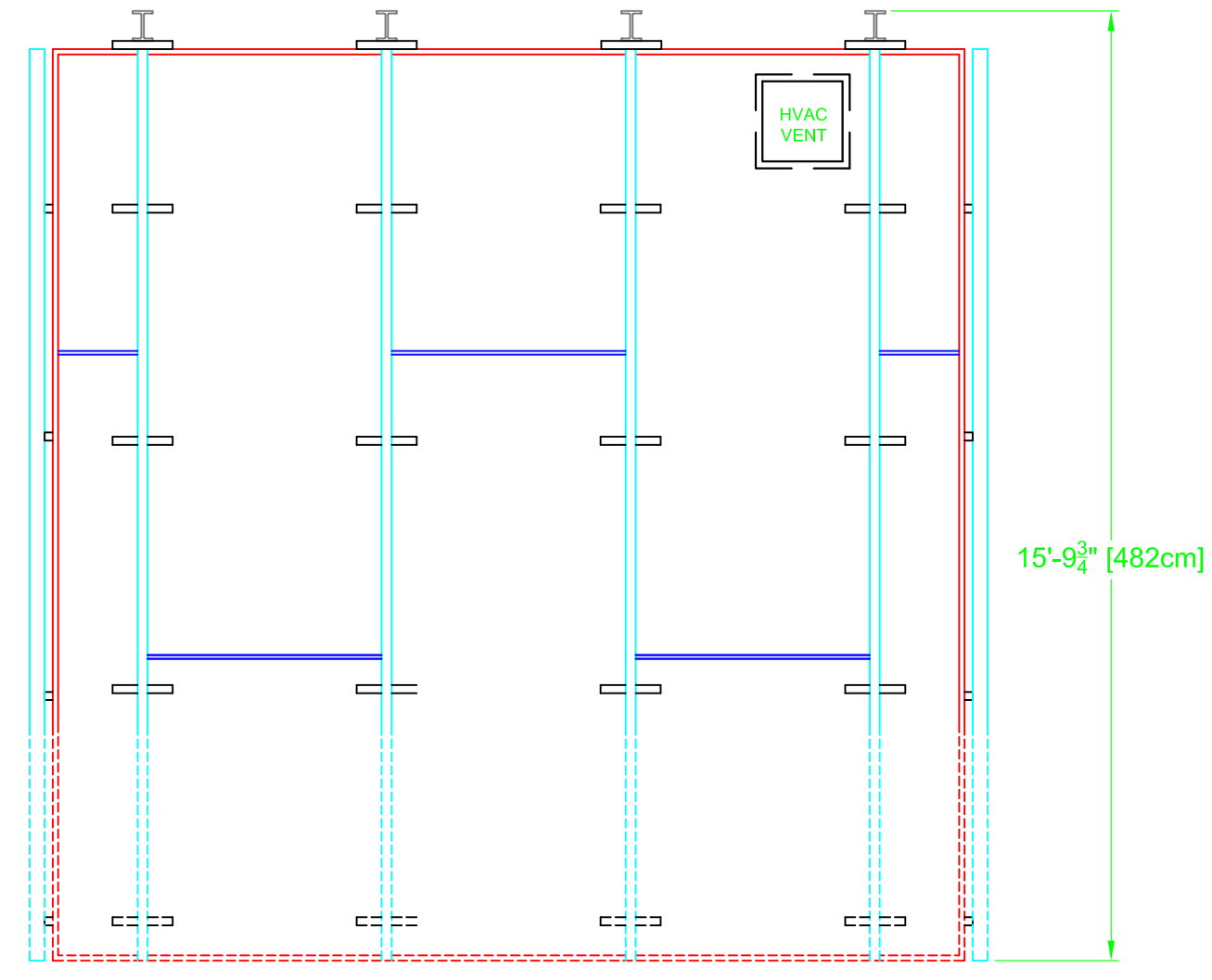

ELEVATION B

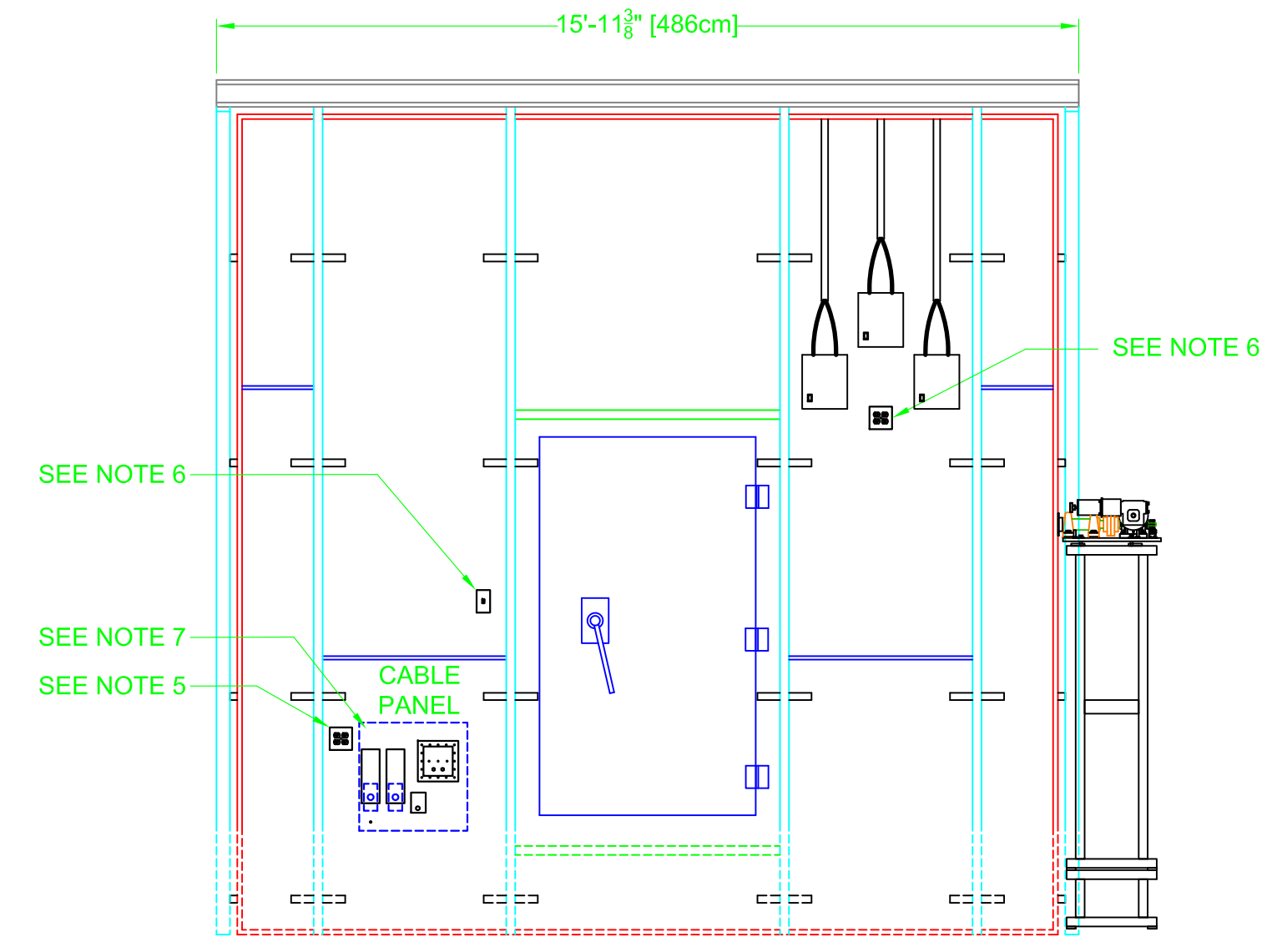

ELEVATION C

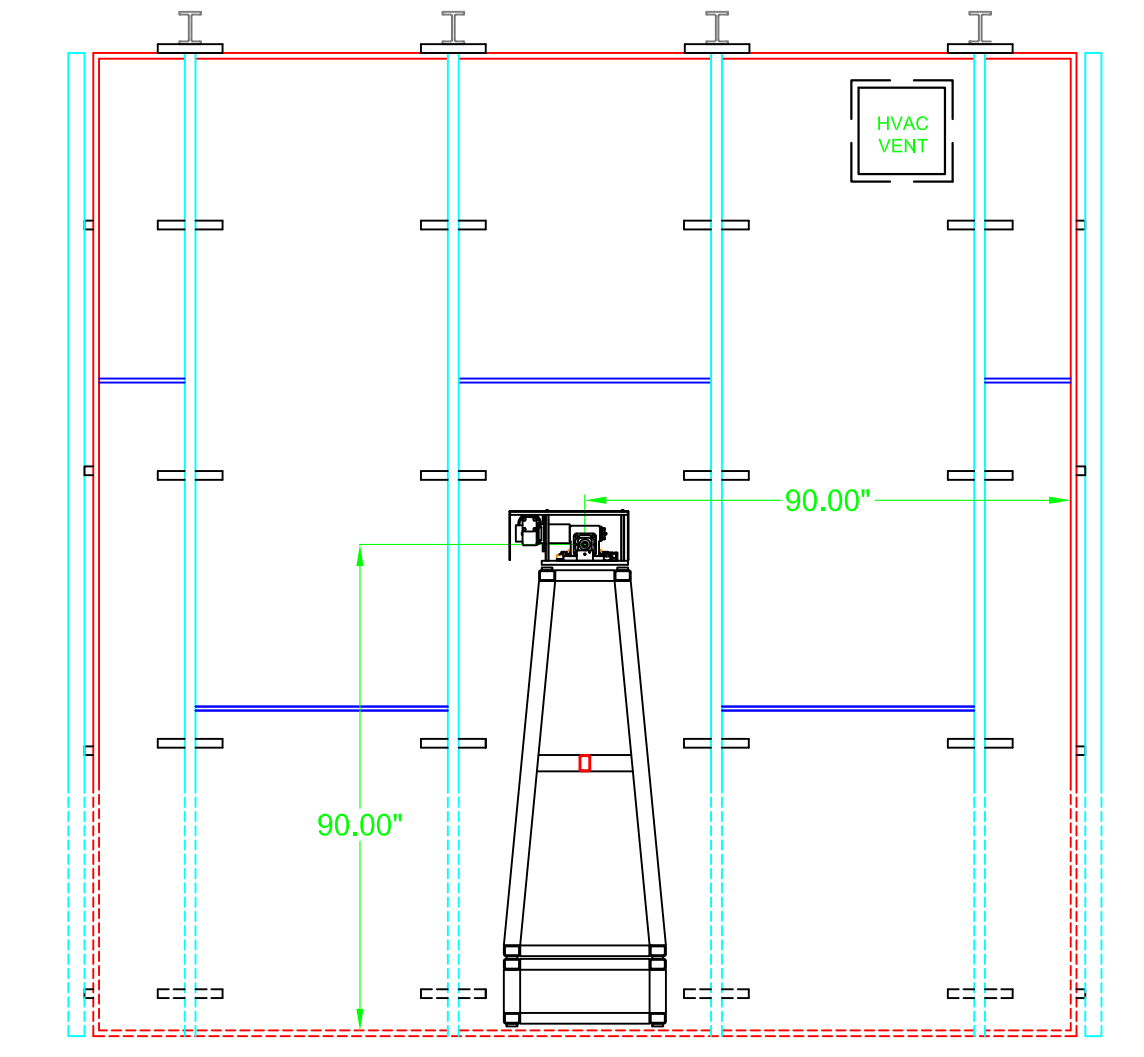

ELEVATION D

NOTES:

GENERAL:

- TEST CHAMBER OUTSIDE DIMENSIONS ARE 192 X 192 X 190 IN HIGH (4.9 X 4.9 X 4.8 M HIGH).
- TEST CHAMBER IS A STAND-ALONE MODULAR SHIELDED CHAMBER LINED WITH RF ANECHOIC MATERIAL. TOTAL SYSTEM WEIGHT IS 15000 LB (6800 KG). MAXIMUM FLOOR LOAD IS 265 LB/SQ FT (1252 KG/SQ M).
- FLOOR SURFACE BENEATH CHAMBER MUST BE SMOOTH AND FLAT TO WITHIN 1/8 IN OVER 10 FT (3 MM OVER 3 M), NON-ACCUMULATING.

ELECTRICAL:

- TEST CHAMBER MUST BE CONNECTED TO HOST BUILDING ELECTRICAL GROUND. A GROUNDING STUD IS PROVIDED WITH THE CHAMBER AND WILL BE FIELD INSTALLED AT A CONVENIENT LOCATION.
- SYSTEM RF AND CONTROL CABLING IS ROUTED TO THE FRONT LEFT SIDE OF THE TEST CHAMBER. AN EQUIPMENT RACK OR TABLE IS REQUIRED TO SUPPORT THE SYSTEM CONTROLLER AND RF EQUIPMENT. TWO DEDICATED ELECTRICAL CIRCUITS ARE REQUIRED TO POWER INSTRUMENTATION EQUIPMENT.
- CHAMBER LIGHTING IS PROVIDED BY FIBER OPTIC LITE PIPES. A DEDICATED ELECTRICAL CIRCUIT IS REQUIRED TO POWER LIGHTING ILLUMINATORS. THE POWER GOING TO THE OUTLET BOX FOR THE LIGHT BOXES IS SWITCHED USING A SWITCH LOCATED ON THE LEFT SIDE OF THE DOOR.
- CHAMBER INTERNAL POWER IS PROVIDED THROUGH A LINE FILTER TO ENSURE ISOLATION AND SHIELDING. INTERNAL POWER SHOULD BE PROVIDED USING A DEDICATED ELECTRICAL CIRCUIT.

HVAC:

- HVAC SUPPLY/RETURN DUCTS ARE 12 IN SQUARE AND HAVE SHEET METAL FLANGES FOR ATTACHMENT OF DUCTING. DUCTING IS NOT REQUIRED FOR RETURN VENT. 70 - 100 CFM AIRFLOW IS SUFFICIENT FOR TEST CHAMBER.

FIRE PROTECTION:

- SPRINKLER DROP PIPES AND HEADS ARE PRE-INSTALLED IN THE CHAMBER. A 1" PIPE NIPPLE EXTENDS THRU THE CHAMBER CEILING TO ALLOW CONNECTION OF EACH SPRINKLER TO THE HOST BUILDING WATER SUPPLY.

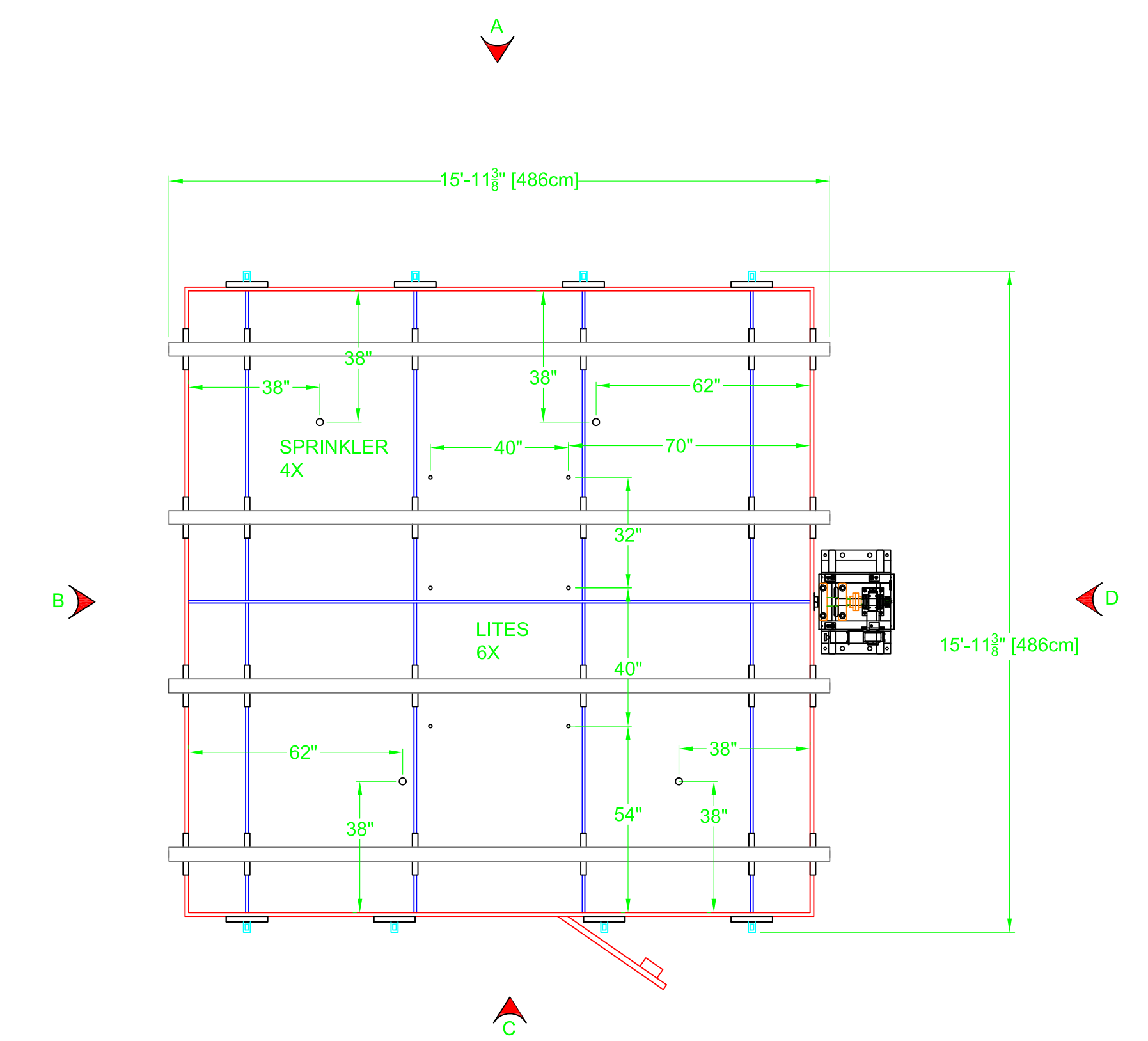

UNLESS OTHERWISE SPECIFIED DIMENSIONS ARE IN INCHES
TOLERANCES:
DECIMAL ANGULAR
.X ±.050 ±0.5°
.XX ±.030
.XXX ±.010

THIRD ANGLE PROJECTION

THE HOWLAND COMPANY, INC.
4540 Atwater Court, Suite 107 Buford, GA 30518
678-546-5680 www.thehowlandcompany.com

TITLE
**4800RH WIRELESS TEST LAB
FACILITY INTERFACE CONTROL DRAWING**

APVD	DATE	SIZE	CAGE CODE	DWG NO	REV
DWN CWS	DATE 4/7/10	D	5V978	P0090325	
DSGN	DATE 6/26/09	SCALE	NTS	SHEET	1 OF 1